

THIS DRAWING IS THE PROPERTY OF FAIRCHILD SEMICONDUCTOR CORPORATION. NO USE THEREOF SHALL BE MADE OTHER THAN AS A REFERENCE FOR PROPOSALS AS SUBMITTED TO FAIRCHILD SEMICONDUCTOR CORPORATION FOR AIDS TO BE EXECUTED IN CONFORMITY WITH SUCH PROPOSALS UNLESS THE CONSENT OF SAID FAIRCHILD SEMICONDUCTOR CORPORATION HAS PREVIOUSLY BEEN OBTAINED. NO PART OF THIS DRAWING SHALL BE COPIED OR DUPLICATED OR ITS CONTENTS DISCLOSED. THE INFORMATION CONTAINED ON THIS DRAWING IS CONFIDENTIAL AND PROPRIETARY.

REVISIONS			
LTR	DESCRIPTION	DATE	NAME/SITE
A	RELEASE TO DOCUMENT CONTROL	9NOV2001	RPM/FSCP
B	PIN 1 MARK FR SQUARE TO CIRCLE; PKG LENGTH&WIDTH TOL FR ± 0.15 TO ± 0.10 ; CHG TOT PKG HEIGHT FR 0.75 MAX TO 0.65 MAX; CHG PKG THICKNES FR 0.50 TO 0.30; CHG BALL HEIGHT FR 0.15 TO 0.22-0.28; CHG BALL COPLANARITY FR 0.075 TO 0.10; CHG BALL DIM FR $\phi 0.18 \pm 0.018$ TO $\phi 0.31 \pm 0.075$; CHG LAND PATTERN DIA DIM FR $\phi 0.16$ TO $\phi 0.25$	1MAR2006	RNM/FSCP
C	CHG LEADER FR GATE PIN MARK TO PIN A1 MARK, REMOVE GATE LEADER ON LAND PATTERN, REMOVED NOTE C, DELETE SINKET FET ON DWG TITLE	18AUG2006	RNM/FSCP
4	CHG PKG WIDTH AND LENGTH TOLERANCE FROM ± 0.10 TO ± 0.05 ; 1.0 ± 0.10 TO 1.0 ± 0.05 AND 1.50 ± 0.10 TO 1.50 ± 0.05 ; TOTAL PACKAGE THICKNESS FROM 0.65 MAX TO 0.6 MAX; CHG COPLANARITY FR 0.10 TO 0.05; ADD NOTE C.	17APR2008	JMM/FSCP

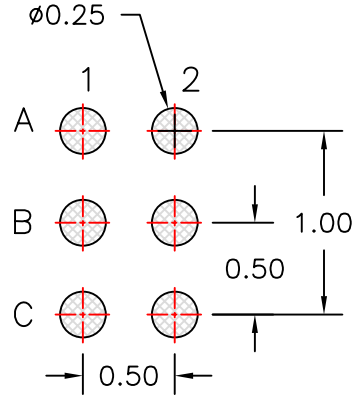

LAND PATTERN RECOMMENDATION

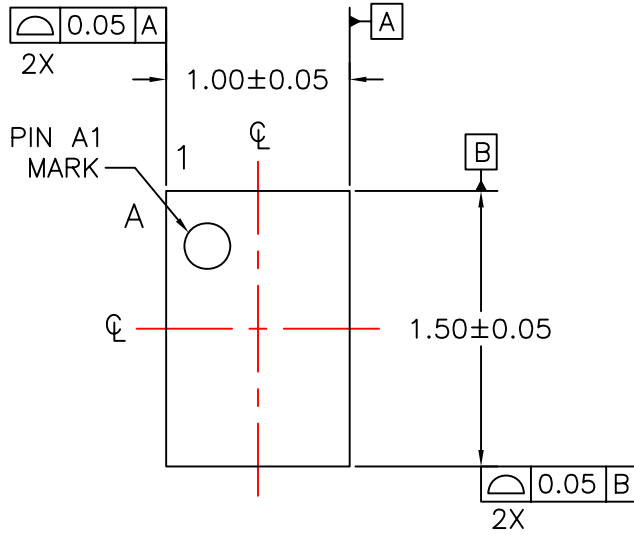
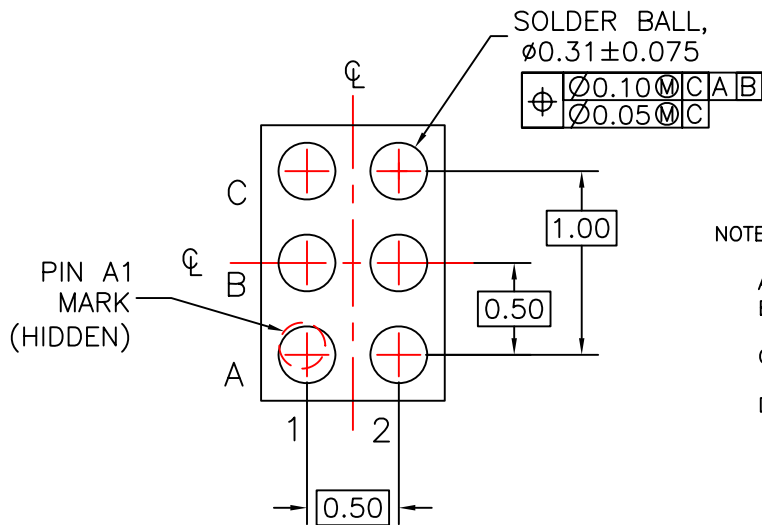
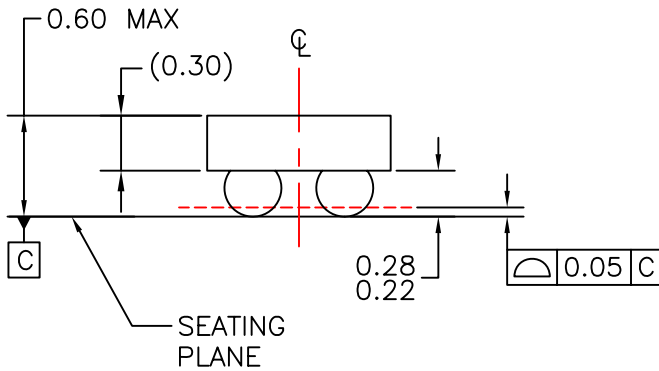

NOTES: UNLESS OTHERWISE SPECIFIED

- A) ALL DIMENSIONS ARE IN MILLIMETERS.
- B) NO JEDEC REGISTRATION REFERENCE AS OF OCTOBER 2005.
- C) DRAWING CONFORMS TO ASME Y14.5M-1994
- D) TERMINAL CONFIGURATION TABLE.

GATE	SOURCE	DRAIN
A1	A2, B1, B2	C1, C2

E) DRAWING FILENAME: MKT-UC006AArev4

APPROVALS	DATE	
DRAWN: J. COMPARATIVO JR. CHECKED: J. V. MANCELITA APPROVED: M. GESTOLE G.S. BAJE	17APR2008	
		SCALE: 1:1 SIZE: NA FORMERLY: N/A
		DRAWING NUMBER: MKT-UC006AA REV: 4 SHEET: 1 OF 1