

44-Lead Metric Quad Flat Pack (MQFP) 3.2mm Footprint Package Dimensions

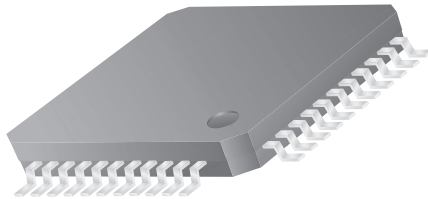

44-Lead Metric Quad Flat Pack (MQFP) 3.2mm Footprint



Symbol	Inches		Millimeters		Notes
	Min.	Max.	Min.	Max.	
A	.077	.093	1.95	2.35	
A1	.000	.010	.00	.25	
A2	.077	.083	1.95	2.11	
B	.012	.018	.30	.46	7
C	.005	.009	.13	.23	
D/E	.510	.530	12.95	13.45	
D1/E1	.390	.398	9.90	10.10	2
e	.0315 BSC		.80 BSC		
L	.029	.041	.73	1.03	6
N	44		44		4
ND	11		11		5
α	0°	7°	0°	7°	
ccc	-	.004	-	0.10	

Notes:

1. All dimensions and tolerances conform to ANSI Y14.5M-1982.
2. Dimensions "D1" and "E1" do not include mold protrusion.
3. Pin 1 identifier is optional.
4. Dimension N: number of terminals.
5. Dimension ND: Number of terminals per package edge.
6. "L" is the length of terminal for soldering to a substrate.
7. "B" includes lead finish thickness.

